

## Installation & Operations Manual

### 2014 Yamaha Viking Soft Doors and Back Panel



#### Installation Information:

This product does not require any modifications to your vehicle. Please familiarize yourself with all the steps before beginning assembly.

#### Compatibility Info:

This windshield is designed to work with other Seizmik branded Accessories for the Viking as well as OEM Yamaha branded hard tops. Please note Seizmik cannot guarantee fitment with other branded aftermarket products. Please research installation details on our products and others when trying to combine different branded accessories.

Seizmik makes Windshields, Mirrors, Cab Systems, Light Bars, Storage Boxes, Hood Racks, and other great accessories for UTV's to maximize the vehicles usefulness. To help you do what you do better.

If you have any questions, comments, need assistance, or are missing parts, please call 1-866-838-3366 between 9:00AM and 5:00PM EST. Or email us at [support@seizmik.com](mailto:support@seizmik.com).

Visit [www.seizmik.com](http://www.seizmik.com) for more information on our products.

#### Hardware

1. M6 x 25mm Button Head Bolt (12)
2. M6 x 35mm Button Head Bolt (2)
3. M6 Locknuts (14)
4. M6 Washers (12)
5. M8 x 80mm Hex Bolt (2)
6. M8 x 70mm Hex Bolt (2)
7. M8 Locknuts (4)

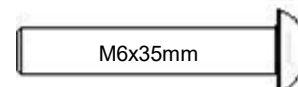
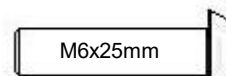

# Parts List

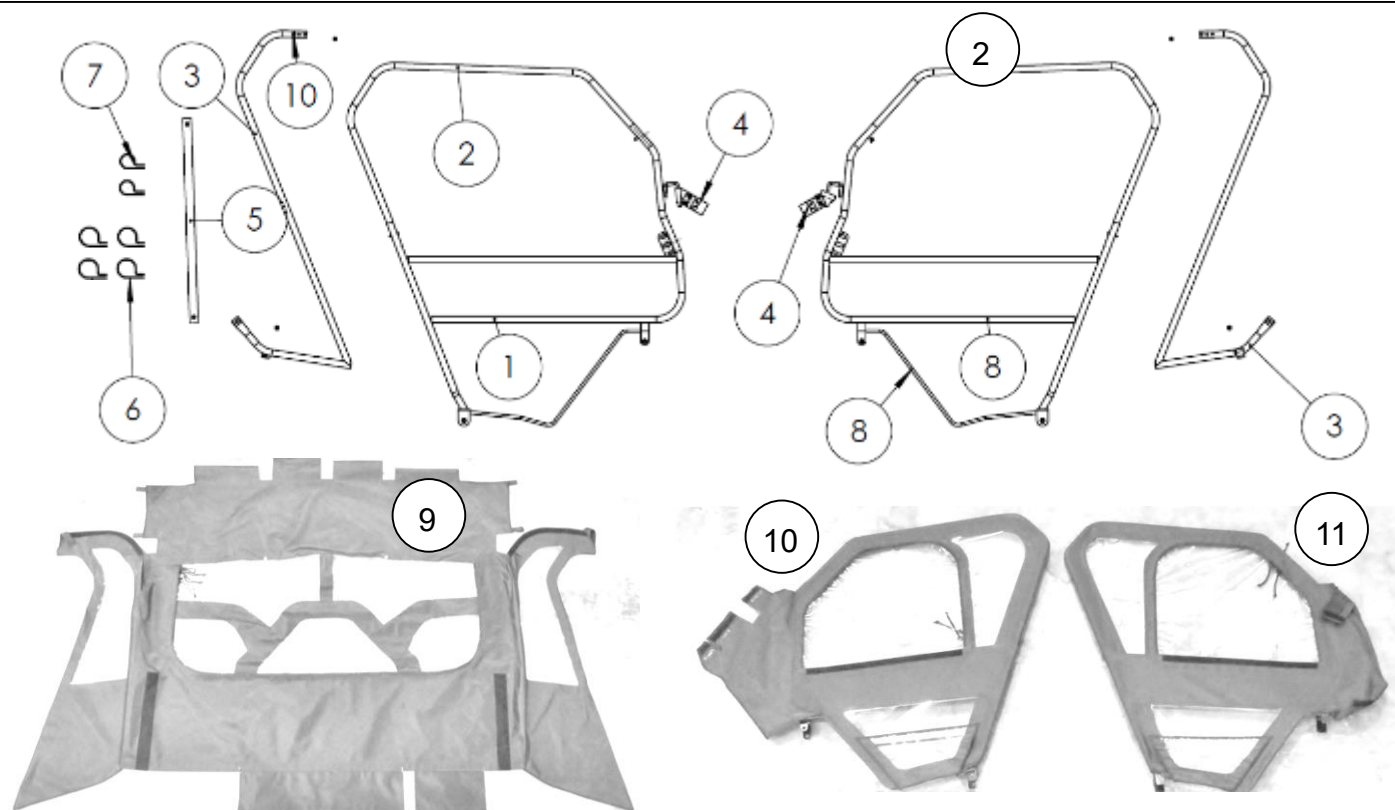

- |                          |                            |                      |
|--------------------------|----------------------------|----------------------|
| 1. Lower Door (R)        | 5. Aluminum Flex Bar (1)   | 9. Back Panel        |
| 2. Upper Door (2)        | 6. 2in Plastic Clamp (4)   | 10. Door Textile (L) |
| 3. Z Tube (L,R)          | 7. 1.5In Plastic Clamp (1) | 11. Door Textile (R) |
| 4. Roll Cage Clamp (L,R) | 8. Lower Door (L)          |                      |



1. Assemble the two halves of the door and secure using two M6x25mm button head bolts. Parts 1 & 2.

For item part numbers refer to the appendix at the back of these instructions.



2. Secure the textiles to the frame using the velcro. NOTE: The textiles are tight in colder weather and 2 may need to be warmed up before installation.





**3.** Attach a clamp on the top crossbar as shown above.



**4.** Attach a clamp in the rear upright bar as shown above

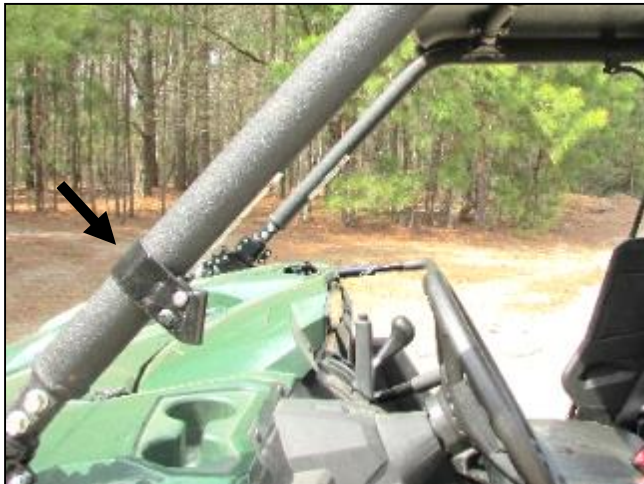

**5.** Attach the door hinge bracket to the front roll cage bar.



**6.** Attach a plastic clamp on the rear bar behind the center headrest. Attach a clamp on the rear upper crossbar as shown above.



**7.** Attach the Z tube to the side of the vehicle with a M6 x 35mm button head bolt on the top clamp and a M6 x 25mm button head bolt on the bottom clamp. Use 2 washers between the plastic clamps and nuts.



**8.** Remove the bolt behind the seat and use to install the Z bracket.





**9.** Attach a plastic clamp on the rear bar behind the center headrest. Attach a clamp on the rear upper crossbar as shown above.



**10.** Attach the aluminum rod onto the top clamp with a M6 x 25mm bolt, nut and washer. Bend the rod down and attach to the other plastic clamp with a bolt, nut and washer. Make sure the bolts face inward to avoid puncturing the textiles.



**11.** Slip the top four flaps of the back panel between the rear upper crossbar and the roof and attach.



**12.** Secure the remaining flaps.



**13.** Secure the back panel around the Z tube. If needed, refasten the Velcro straps to adjust the fitment of the textiles.



**14.** Match the velcro strip near the loop and velcro on the flap and attach.



**15.** Pull the loop through the side of the vehicle between the roll cage and roof.

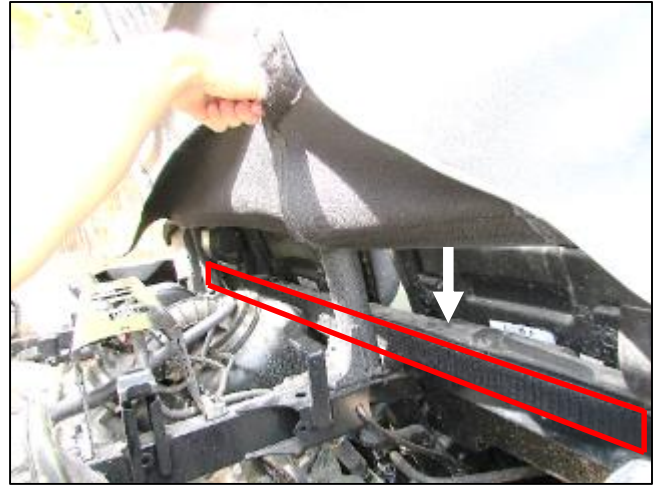

**16.** Attach a strip of self adhesive Velcro on the back side of the cab on the lower crossbar. Attach back panel lower flaps.



**17.** Secure the back panel with two Velcro loops around the rear pillars of the cab. There is one behind the passenger and drivers seats.



**18.** Place Seizmik door on OEM Viking door and roll cage barrel clamp. Adjust position of the door and tighten the roll cage barrel clamp bolts.

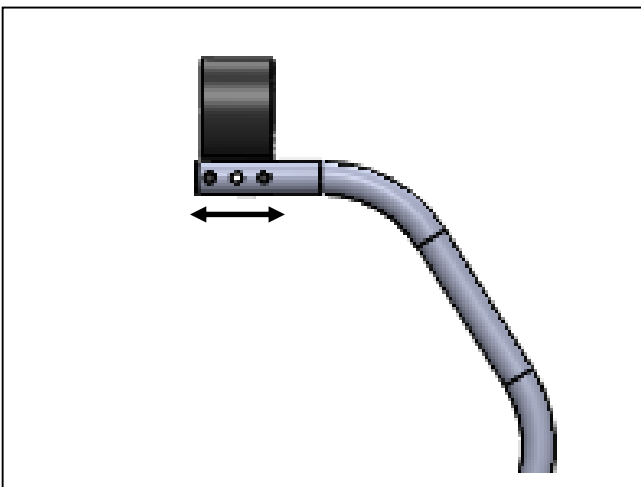

**19.** Adjust the Z tube by mounting the clamp in the forward, middle, or rear hole as needed. This will allow you to minimize the gap between the door and the subframe. The holes allow you to move the bar without having to move the clamp.



**20.** Locate the holes on the door based on the door location. Mark and drill through OEM Viking door. Secure with bolts and locknuts. Use the M8x70mm bolt for the front part of the door, and M8x80mm





**21.** Secure the remaining flaps on the front roll cage bar of the vehicle. If needed, refasten the velcro straps to adjust the fitment of the textiles.



**22.** Attach a strip of Velcro on the back side of the cab on the lower crossbar. Attach back panel lower flaps.



**23.** To roll up the back window, unzip the vinyl section and roll up. Use the vinyl straps to secure the rolled section.

## APPENDIX

Yamaha Viking Soft Doors and Back Panel (06014)		
Item #	Part#	Description
2	54-SW-90440	Upper door frame
8	54-SW-90441	Lower door frame <b>driver side</b>
1	54-SW-90442	Lower door frame <b>passenger side</b>
3	54-SW-90443	Z tube <b>driver side</b>
3	54-SW-90444	Z tube <b>passenger side</b>
	54-SW-90445	Door hinge bracket <b>driver side</b>
	54-SW-90446	Door hinge bracket <b>passenger side</b>
5	54-SW-90447	Aluminum flex bar
6	54-SW-90333	2" Plastic clamp
7	54-SW-90448	1.5" plastic P clamp
	54-SW-90449	Back panel/sub frame textile combo
10	54-SW-90450	Door textile <b>driver side</b>
11	54-SW-90451	Door textile <b>passenger side</b>
	54-SW-90452	Hardware kit

